

1 Have you got everything?

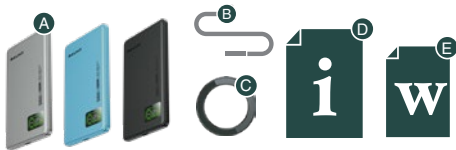

- A. 5000mAh Slim Magnetic Wireless Powerbank with UI Display
- B. USB-C to USB-C Cable
- C. Metal Ring
- D. User Guide
- E. Warranty Certificate

Note: Only Power bank (Grey / Blue / Black) is supplied.

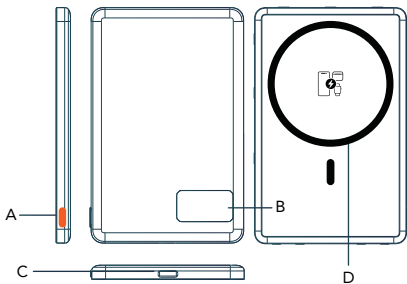

2 Product Overview

- A. Power Button
- B. LCD Display
 - Battery Percentage
 - Charging Speed Indicator
- C. USB-C Input / Output
- D. Magnetic Charging Pad

3 Operation

Power on/off

- Press the POWER button to turn on the power bank. The LCD display will light up and show the remaining power.
- Short press the POWER button twice to turn off the power bank. If no devices are being charged or the charging load is too low, the power bank will turn off after about 35 seconds.

Charging your devices

- Magnetic wireless charging pad for compatible mobile phone
Place your mobile phone on the centre of the charging pad, display screen facing up to charge. The LCD display indicates battery percentage and charging speed.
- Wireless charging pad for compatible earphones or earbuds device
- Wireless charging pad for compatible smart watch
- USB-C wired charging output
Plug one end of your USB-C cable into the USB-C port, and the other end into your mobile device.
Note: PD (Power Delivery) is supported via the correct USB-C cables and devices.
The power bank will automatically quit the wireless charging mode if there is USB-C wired output connected. Press the POWER button again to activate the wireless charging function.

Use metal ring

- If your smart phone doesn't support magnetic, please put the metal ring into or onto your smart phone protective case and align it to the smart phone's wireless charging coil (detail location please refer to the specification of your smart phone). The metal ring is for temporary mounting only. Holding time varies depending on surface.



Choose a smooth phone case and clean it.



Affix the metal ring inside or outside the phone case.



Note: It is recommended to affix the metal ring outside the phone case.

Charging your power bank

- Connect the supplied USB-C cable to the USB-C port of the power bank and the other end to your power source. The LCD display indicates the battery percentage and charging speed.
- The USB-C port can be used for both charging the power bank and device.
- If you connect devices to the power bank while it is charging. Power will be shared and charging time will be extended.

Troubleshooting

Cannot charge device

- Make sure the USB cable is plugged into the output port; unplug the USB cable and try again.
- Try another USB cable.
- Some devices require higher outputs to charge. Please check with your device's spec to confirm compatibility.
- Keep the power bank away from heat, high temperatures and direct sunlight.

Wireless charging not working

- Check your smart phone, earbuds charging case and smart watch supports wireless charging.
- Ensure your device is facing up and aligned to the centre of the wireless charging pad.
- Remove any metal or other objects between your device and the wireless charging pad.

No Digital Display when charging device

- Connect the power bank to your power source to ensure the power bank has sufficient power.
- Press the POWER button to check battery status.

Capacity drops

- It is normal for the capacity to slowly drop after a certain usage cycle.

Give us a call

What? You mean this User Guide didn't have ALL the answers? Speak to us! We'd love to help you get up and running as quickly as possible.

Call our **After Sales Support** on **1300 002 534**

Operating hours: Monday-Friday, 8:30am-6pm; Saturday, 9am-6pm AEST



Specifications

Power Bank Capacity	5000mAh, 19.6Wh
Input	USB-C 5V \approx 3A, 9V \approx 2A (18W Max)
Output*	USB-C Output: 5V \approx 3A, 9V \approx 2.22A, 12V \approx 1.67A (20W Max) Wireless Output: Phone 15W Max, Earbuds 5W Max, Watch 2.5W Max Total Output: 15W Max if more than 1 output in use
Battery	Li-ion Polymer 3.92V 5000mAh, 19.6Wh
Dimensions	102 x 66 x 8.5mm
Weight	112g

* Output is dependent on the mobile device's input power and the charging cable.
* Compatible with Apple watches from series 2 onwards.

General Safety Warnings

For the safety of yourself and others, follow all instructions and take notice of all the warnings. When adhered to, these safety precautions can reduce the risk of fire, electric shock and injury.

This product complies with Australian Safety standard AS/NZS 62368.1 to ensure the safety of the product.



The RCM is a visible indication of a product's compliance with all applicable ACMA regulatory arrangements, including all technical and record-keeping requirements.



Class III appliance is designed to be supplied from a separated extra-low voltage (SELV) power source.

IMPORTANT

Plastic wrapping can be a suffocation hazard for babies and young children, so ensure all packaging materials are out of their reach.

To prevent environmental factors (dampness, dust, food, liquid etc.) harming the power bank, only use it in a well-ventilated, clean and dry environment, away from excessive heat or moisture.

Keep the product away from direct sunlight or heat sources.

In case of damage, do not disassemble, repair or modify the product yourself. Contact After Sales Support for advice on repair or replacement, or refer servicing to qualified personnel only.

Children should be supervised to ensure they do not play with the product.

Do not put any object on top of the product.

Do not place or store appliance where it can fall or be pulled into a bath or sink.

This product is not intended for use by persons (including children) with reduced physical, sensory or mental capabilities, or lack of experience and knowledge, unless they have been given supervision or instruction concerning use of the product by a person responsible for their safety.

Responsible disposal of the packaging

The packaging of your product has been selected from environmentally friendly materials and can usually be recycled. Please ensure these are disposed of correctly. Plastic wrapping can be a suffocation hazard for babies and young children, please ensure all packaging materials are out of reach and are safely disposed of. Please recycle these materials rather than throwing them away.

Disposal of a battery into fire or a hot oven, or mechanically crushing or cutting of a battery, that can result in an explosion.

Leaving a battery in an extremely high temperature surrounding environment that can result in an explosion or the leakage of flammable liquid or gas.

A battery subjected to extremely low air pressure that may result in an explosion or the leakage of flammable liquid or gas.

Do not use a charging adapter exceeding the product specifications for charging.

Do not expose the product to microwaves.

Clean using a dry cloth only - do not use water or chemicals.

Keep the product away from oils, chemicals or any other organic liquids.

Use this appliance only for its intended purpose as described in this guide.

Responsible disposal of the product

At the end of its working life, do not throw this product out with your household rubbish. An environmentally friendly method of disposal will ensure that valuable raw materials can be recycled. Electrical and electronic items contain materials and substances which, if handled or disposed of incorrectly, could potentially be hazardous to the environment and human health.



CAUTION
The battery in this device is non replaceable.