

1 Have you got everything?



Note: Only one set of plugs (black or white) is supplied.

Note: Only one travel adapter (black or white) is supplied.

- A. Travel Adapter Power Bank
- B. 4 x Travel plug adapters
- C. User Guide
- D. Warranty Certificate
- E. Travel Kit
- F. Carry Strap



Control and Buttons

2



Install the travel adaptor plug and slide onto the pins located at the corner of the Power bank.
Gently push on before sliding to remove and change plugs.

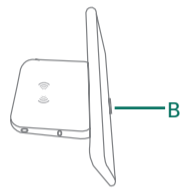
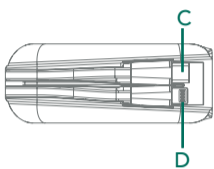

Travel Adaptor Power Bank

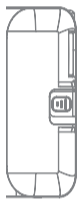
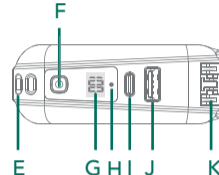

- A. Kickstand retracted
- B. Kickstand extended
- C. USB-C Cable
- D. Lightning Cable
- E. Lanyard Attachment
- F. On/Off Button

- G. LED Display (battery capacity)
- H. LED Indicator (power bank status)
- I. USB-C input/output
- J. USB-A output
- K. AC input Plug
- L. Wireless Charging

Operation

3

Power on/off

- Press the power button to turn on the power bank, the LED display will light up and show the remaining power.
- Press the power button twice to turn off the power bank.

Charging your devices

- Unfold the USB cable (attached), either USB-C or lightning cable and connect to the port on your device.
- You can also use a separate USB-A or USB-C cable (not included) to charge your mobile devices.
- The LED display shows the power remaining as a percentage from 0%-100%. When the remaining power drops lower than 5%, the LED display starts blinking to display the low power warning.
- When the USB-A or USB-C fast charging mode is activated, the LED indicator will light up red.
- When charging multiple devices at same time, the power bank will exit fast charging mode and it will share charging power to your connected devices. The red LED indicator will turn off.

Wireless Charging:

When the power bank is switched on, the LED indicator will light up green which indicates the wireless charging function is activated. Place your smart phone facing up on the wireless charging pad. Make sure your phone is correctly aligned and has started charging.

Note: If the LED indicator is not green, the power bank may have entered protection mode. This is due to other devices being connected to USB-A or USB-C ports in fast charging mode. Press the power button to quit that fast charging mode to activate the wireless charging.

If the LED indicator is flashing green, this means an error has occurred. Either the smart phone does not support wireless charging or other objects are obstructing the wireless charging pad.

Note: The power bank will automatically quit the wireless charging mode in 30s to save power if the wireless charging load is too low. Press the power button again to activate the wireless charging function.

Trickle Charging Mode:

- Press and hold the power button to activate trickle charging mode for charging low-power devices such as smart watches, smart bands and earbuds. The unit digit of the LCD display will flash to indicate this mode.
- The power bank will auto turn off the trickle charging mode after approximately 2 hours.
- Press and hold the power button to manually turn off trickle charging mode.
- If high-power devices are connected, the power bank will automatically turn off trickle charging mode.

Charging your power bank

- Plug the travel adapter power bank into either mains power or the USB-C input until fully charged.
- Charge for 3-5 hours to fully charge the power bank before use.

Note: Charging time is about 3 hours when using USB-C fast charging input. It is about 5 hours when using mains power input.

- When the USB-C fast charging input activated, the LED indicator will light red.
- If you connect devices to the power bank while it is charging. Power will be shared and charging time will be extended.

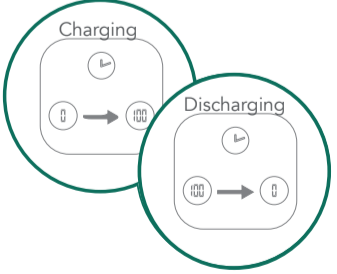
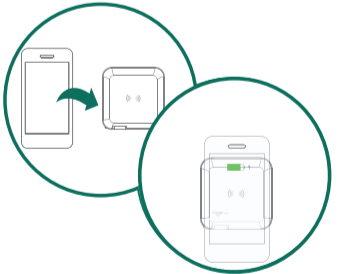
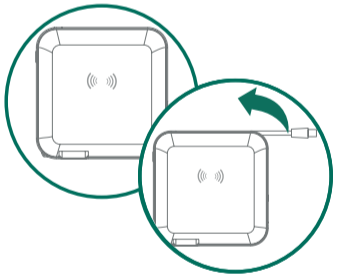
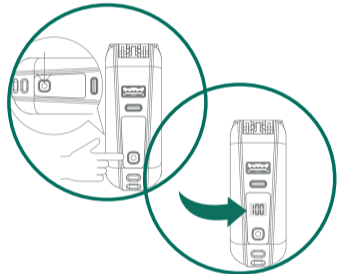

Inputs



AC Input

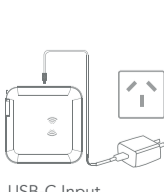

USB-C Input

Outputs

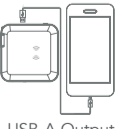

USB-A Output

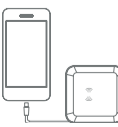

USB-C Cable Output



USB-C Output

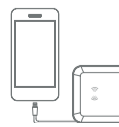

Lightning Cable Output



Wireless Output



Troubleshooting

Device is not charging	<ul style="list-style-type: none">• Make sure the USB cable is plugged into the output port; unplug the USB cable and try again.• Try another USB charging cable.• The power bank will turn off automatically when an minimum load (about 80mA) is not detected.• Some devices require a higher outputs to charge. Please check with your devices specification to confirm compatibility.• The power bank has built-in temperature protect sensor. Keep the power bank away from heat, high temperatures and direct sunlight.
Wireless charging not working	<ul style="list-style-type: none">• Press the power on button to turn the powerbank on.• Check that your smart phone supports wireless charging.• If you have a smart phone case, you must remove when charging.• Ensure your smart phone is facing up and aligned to the centre of the wireless charging pad, and remove any metal or other objects between the smart phone and the wireless charging pad.
Cannot charge device whilst charging power bank	<ul style="list-style-type: none">• The power bank does not support supplying power while it is in fast charging mode. Please wait until the power bank is fully charged or press the power button to quit fast charging mode..
No LED light when charging device	<ul style="list-style-type: none">• Connect the power bank to a power source to ensure the power bank has sufficient battery.
Capacity drops	<ul style="list-style-type: none">• It is normal for the capacity to slowly drop after a certain usage cycle.



Specifications

Travel Adaptor Power Bank

Input	AC 100~240V 50/60Hz 0.3A (Max) USB-C 5V≡3A, 9V≡2A, (18W Max)
Battery	Li-ion Polymer 3.7V, 10000mAh, 37Wh
Output	USB-C: 5V≡3A, 9V≡2.22A, 12V≡1.67A (20W Max) USB-A: 5V≡3A, 9V≡2A, 12V≡1.5A, (18W Max) Wireless 5W, 7.5W, 10W, 15W USB-C Cable: 5V≡3A, (15W Max) Lightning cable: 5V≡2.4A (Total Output: 15W Max if more than 1 output used.)
Dimensions	86 x 86 x 33 mm
Weight	265g



Give us a call

What? You mean this User Guide didn't have ALL the answers? Speak to us!
We'd love to help you get up and running as quickly as possible.
Call our **After Sales Support** on **1300 002 534**.
Operating hours: Monday-Friday, 8:30am-6pm; Saturday, 9am-6pm AEST

General Safety Warnings

For the safety of yourself and others, follow all instructions and take notice of all the warnings. When adhered to, these safety precautions can reduce the risk of fire, electric shock and injury.

This product complies with Australian Safety standard AS/NZS 62368.1 to ensure the safety of the product.



The RCM is a visible indication of a product's compliance with all applicable ACMA regulatory arrangements, including all technical and record-keeping requirements.

IMPORTANT

Plastic wrapping can be a suffocation hazard for babies and young children, so ensure all packaging materials are out of their reach.

To prevent environmental factors (dampness, dust, food, liquid etc.) harming the power bank, only use it in a well-ventilated, clean and dry environment, away from excessive heat or moisture.

Keep the product away from direct sunlight or heat sources.

In case of damage, do not disassemble, repair or modify the product yourself. Contact After Sales Support for advice on repair or replacement, or refer servicing to qualified personnel only.

Children should be supervised to ensure they do not play with the product.

Do not put any object on top of the product.

Do not place or store appliance where it can fall or be pulled into a bath or sink.

This product is not intended for use by persons (including children) with reduced physical, sensory or mental capabilities, or lack of experience and knowledge, unless they have been given supervision or instruction concerning use of the product by a person responsible for their safety.

Do not expose the product to microwaves.

Clean using a dry cloth only.

Do not use water or chemicals.

Keep the product away from oils, chemicals or any other organic liquids.

Use this appliance only for its intended purpose as described in this guide.

Responsible disposal of the packaging

The packaging of your product has been selected from environmentally friendly materials and can usually be recycled. Please ensure these are disposed of correctly. Plastic wrapping can be a suffocation hazard for babies and young children, please ensure all packaging materials are out of reach and are safely disposed of. Please recycle these materials rather than throwing them away.

Responsible disposal of the product

At the end of its working life, do not throw this product out with your household rubbish. An environmentally friendly method of disposal will ensure that valuable raw materials can be recycled. Electrical and electronic items contain materials and substances which, if handled or disposed of incorrectly, could potentially be hazardous to the environment and human health.



CLASS II - DOUBLE INSULATED APPLIANCE

This symbol indicates that the appliance has been designed in such a way that it does not require a safety connection to electrical earth (ground).

Enjoy using your product!

Well done, you made it.
Now sit back and relax... your product is automatically covered by a 1-year warranty.
How nice!