

## 1 Have you got everything?

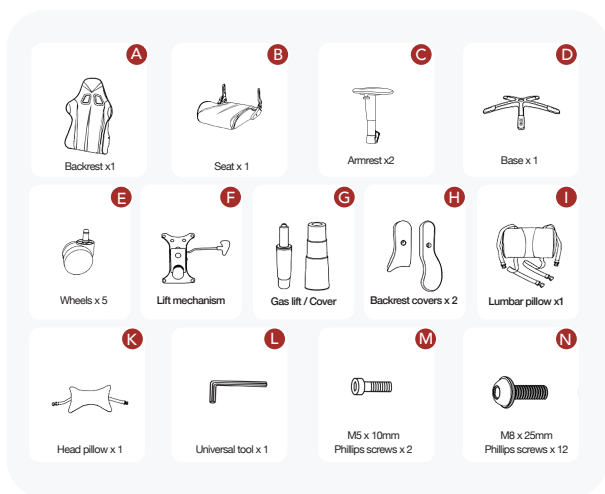

## 2 Product Overview

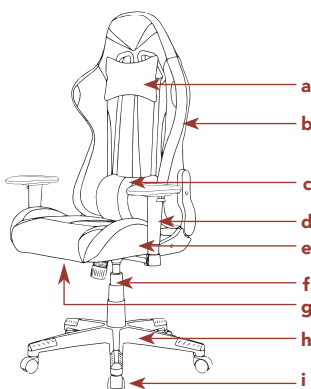

- a. Head Pillow
- b. Backrest
- c. Lumbar Pillow
- d. Armrest
- e. Seat
- f. Gas lift & cover
- g. Tilt mechanism
- h. Base
- i. Wheels

## 3 ASSEMBLY

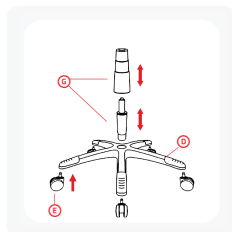

### Step 1:

- Press each of the 5 wheels ⑤ into the base.
- Press the large end of the gas lift ⑥ into the base ④.
- Place the gas lift cover ⑦ over the top.



### Step 2:

- Using the supplied tool ①.
- Use 4 x screws ① to attach the backrest ② to the seat ③.

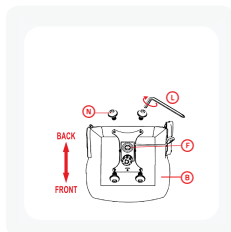

### Step 3:

- Using the supplied tool ①.
- Use 4 x screws ① to attach the Lift mechanism ⑥ to the seat ⑤.

*Note: the front of the base is mark with the word "front".*

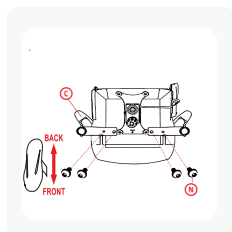

### Step 4:

- Using the supplied tool ①.
- Use 4 x screws ① to attach the armrests.
- The left and right armrest are identified with a "L" or "R" sticker.
- Adjust the distance between the armrests to a comfortable width.



### Step 5:

- Using the supplied tool ①.
- Use 2 x screws ① to attach the backrest covers ⑧.

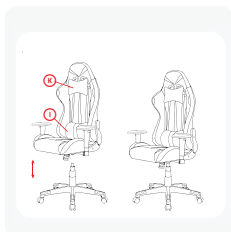

### Step 6:

- Attach the lumbar pillow ⑨ and head pillow ⑪ to the seat using the elastic straps.
- Place the completed seat onto the assembled base.

Well done, you made it.  
Now sit back and relax... your product is automatically covered by a 3-year warranty.  
How nice!

Enjoy using your product!

**Backrest Recline lever**

**Seat Height lever**

**Seat Width Adjustment screw**

**Armrest Height Adjustment lever**

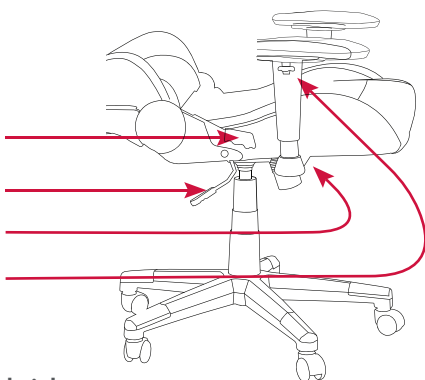

#### Adjusting the seat height

- Pull the seat height lever and remain seated to lower or remove weight from chair to raise.

#### Adjusting the backrest recline:

- Pull the backrest recline lever and push the backrest rearward to increase recline or lean forward to reduce the incline.

#### Adjusting the seat width

- Adjust the distance between the two armrests by loosening the two attaching screws under the armrest. Adjust the armrest a comfortable position. Then retighten the screws.

#### Adjusting the armrest height

- Slide the lever up and push or pull to adjust the armrest height.

#### Adjusting for best ergonomics:

- Adjust your chair height so your elbows are level with the desk surface, enabling relaxed arms and shoulders.
- Place your feet flat on the floor. Use a foot rest if necessary. (Not supplied)
- Set the lumbar so it provides support in your lower back.
- Allow for 3 fingers distance behind your knees, to enable good blood flow.
- Tilt the backrest so you have a hip angle of 100 to 120 degrees.
- Keep chair close enough to the desk so forearms are supported and you are not leaning on the backrest.

## Troubleshooting



Seat feels unstable	<ul style="list-style-type: none"> <li>• Check the lift mechanism has been firmly attached.</li> </ul>
Seat is not assembling correctly	<ul style="list-style-type: none"> <li>• Check base is orientated correctly. (Front is marked on lift mechanism)</li> <li>• Check the armrests are placed on the correct side by ensuring the pointed end faces towards the front.</li> </ul>
Seat not adjusting up/down	<ul style="list-style-type: none"> <li>• Use the lift mechanism attached to the seat to adjust the seat height.</li> </ul>
Seat not reclining	<ul style="list-style-type: none"> <li>• Use the lever at the base of the backrest to adjust the reclined position.</li> </ul>



## Give us a call

What? You mean this User Guide didn't have ALL the answers? Speak to us!

We'd love to help you get up and running as quickly as possible.

Call our **After Sales Support** on **1300 002 534**.

Operating hours: Monday-Friday, 8:30am-6pm; Saturday, 9am-6pm AEST



## Specifications

Gaming Chair	360° swivel 90° - 165° reclining backrest Seat is 10 cm height adjustable Armrest is 7.5 cm height adjustable
Gaming chair weight	Net 16.8 kg (approx.) Gross 19 kg (approx.)
Supported weight	120 kg Max.
Dimensions	70 cm (D) x 73 cm (W) x 124-134 cm (H)

# General Safety Warnings

For the safety of yourself and others, follow all instructions and take notice of all the warnings. When adhered to, these safety precautions can reduce the risk of fire, electric shock and injury.

## IMPORTANT

### Usage Environment

- When using the equipment, make sure to place it:
- Away from heat sources such as radiators, heat registers, stoves or other equipment (including amplifiers that produce heat).
- Away from areas with high temperatures, high humidity or direct sunlight.
- Away from excess dirt and dust.

### Usage Conditions and Restrictions

- Instructions: Follow the instructions in this manual when installing and adjusting this equipment. Only adjust those controls that are covered in this instruction manual, as improper adjustment of other controls may result in damage.
- Usage restriction: The equipment is not intended for use by persons (including children) with reduced physical, sensory or mental capabilities, or lack of experience and knowledge, unless they have been given supervision or instruction concerning use of the by a person responsible for appliance their safety.
- Children: Young children should be supervised to ensure they do not play with the equipment.
- Close supervision is always necessary when an appliance is used by or near children.
- Protect the equipment: Prevent metal objects falling onto the equipment.
- Do not stand on the chair or use it as a ladder.
- Do not place objects filled with water or naked flame sources (such as candles) near the equipment.

- This product is to be used for private indoor use only.
- Don't allow children to operate the gaming chair, it is not toy.

### Responsible disposal of the product

At the end of its working life, do not throw this product out with your household rubbish. An environmentally friendly method of disposal will ensure that valuable raw materials can be recycled. Contact your local authority for your nearest recycling centre.

### Responsible disposal of the packaging

The packaging of the product has been selected from environmentally friendly materials and can usually be recycled. Please ensure these are disposed of correctly. Plastic wrapping can be a suffocation hazard for babies and young children, please ensure all packaging materials are out of reach and are safely disposed of. Please ensure they are offered for recycling rather than throwing these materials away.

### Cleaning the product

Only use a soft, dry cloth for cleaning the product; do not use a damp cloth. Never clean with industrial strength polish, wax, benzene, paint thinner, air freshener, lubricant, detergent or other chemicals.

## WARNING!

- Pull the reclining adjustment lever and push the backrest rearward to increase reclining or lean forward to reduce the incline. Don't adjust the reclining without resistance on the backrest. Doing so will cause the backrest to move at high speed.

## GENERAL SAFETY WARNINGS

BAUHN® is a registered trademark of ALDI Stores. ALDI guarantees that our exclusive brand products are developed to our stringent quality specifications. If you are not entirely satisfied with this product, please return it to your nearest ALDI store within 60 days from the date of purchase for a full refund or replacement, or take advantage of our after sales support by calling the supplier's Customer Service Hotline.

ALDI STORES, 1 SARGENTS ROAD  
MINCHINBURY NSW 2770 [www.aldi.com.au](http://www.aldi.com.au)

Distributed by Tempo (Aust) Pty Ltd, PO BOX 6097,  
North Sydney NSW 2059, Australia

Made in China. V1.0



**BAUHN®**

## Warranty Information

The product is guaranteed to be free from defects in workmanship and parts for a period of 36 months from the date of purchase. Defects that occur within this warranty period, under normal use and care, will be repaired, replaced or refunded at our discretion, solely at our option with no charge for parts and labour. The benefits conferred by this warranty are in addition to all rights and remedies in respect of the product that the consumer has under the Competition and Consumer Act 2010 and similar state and territory laws.

Our goods come with guarantees that cannot be excluded under the Australian Consumer Law. You are entitled to a replacement or refund for a major failure and to compensation for any other reasonably foreseeable loss or damage. You are also entitled to have the goods repaired or replaced if the goods fail to be of acceptable quality and the failure does not amount to a major failure.

## Repair and Refurbished Goods or Parts Notice

Unfortunately, sometimes faulty products are manufactured, which need to be returned to the supplier for repair. Please be aware that if your product is capable of retaining user-generated data (such as files stored on a computer hard drive, telephone numbers stored on a mobile telephone, songs stored on a portable media player, games saved on a games console or files stored on a USB memory stick) during the process of repair, some or all of your stored data may be lost. We recommend you save this data elsewhere prior to sending the product for repair.

You should also be aware that rather than repairing goods, we may replace them with refurbished goods of the same type or use refurbished parts in the repair process.

Please be assured though, refurbished parts or replacements are only used where they meet ALDI's stringent quality specifications. If at any time you feel your repair is being handled unsatisfactorily, you may escalate your complaint. Please telephone us on 1300 002 534 or write to us at:

Tempo (Aust) Pty Ltd ABN 70 106 100 252  
PO BOX 6097, North Sydney, NSW, 2059, Australia  
Telephone: 1300 002 534 (Aust) Fax: (02) 8977 3765  
Tempo Help Desk: 1300 002 534 (Aust)  
(Operating Hours: Mon-Fri 8:30am-6pm; Sat 9am-6pm AEST)  
Email: [tempo.org/support](mailto:tempo.org/support)