

# User Guide

Model: APGS-1222  
Portable Green Screen

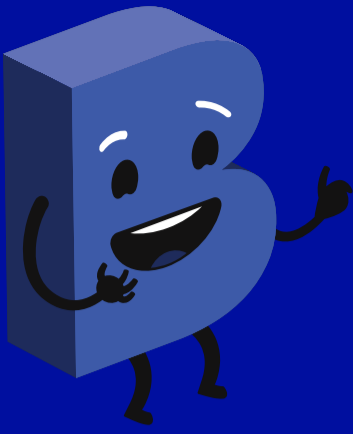

Hey!  
Let's get your new product  
ready to use, fast!

## 1 Have you got everything?

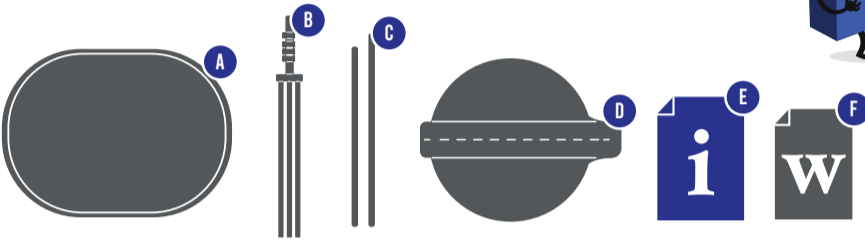

A. Portable Green Screen  
B. Foldable Metal Stand

C. Top Mount Bar  
D. Carry Bag

E. User Guide  
F. Warranty Certificate

## Setting up

# 2



Open the tripod and loosen the base adjustment lock as pictured. The tripod legs will automatically extend out. Once the legs are stable, tighten the base adjustment lock to hold the legs in place.

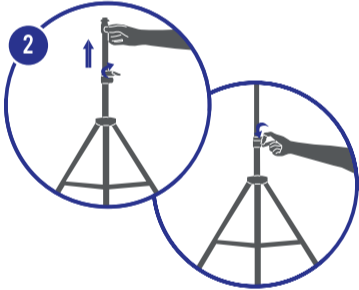

Loosen the height adjustment lock and pull out the vertical pole until fully extended. During this process, hold onto the tripod base so the legs are stable and do not move around. Once the vertical pole is fully extended, tighten the height adjustment lock.

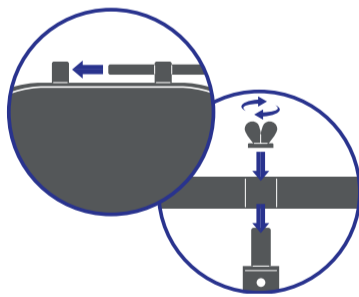

### Mounting for Landscape Orientation

Slide the top mount bar through the 2 hang tabs on the green screen, making sure the mount bar is centre aligned with the green screen.

Insert the top mount bar onto the top of the vertical pole as illustrated. Once in, secure the mount bar by inserting and twisting the lock cap.

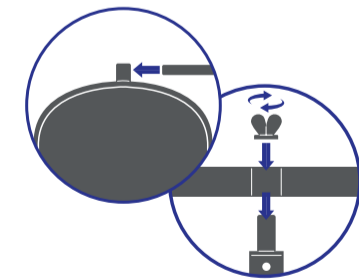

### Mounting for Portrait Orientation

Rotate the green screen so that it is vertically standing. Slide the top mount bar through the hang tab on the green screen, making sure the mount bar is centre aligned with the green screen.

Insert the top mount bar onto the top of the vertical pole as illustrated. Once in, secure the mount bar by inserting and twisting the lock cap.

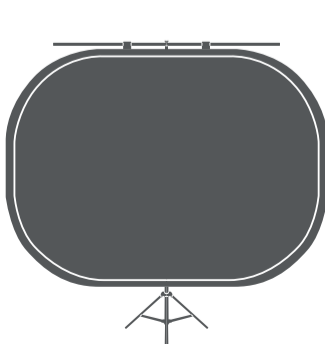

Landscape orientation

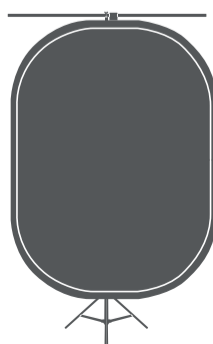

Portrait orientation

## 3 Packing the green screen

The green screen comes with a carry bag to pack into, so you can take it anywhere you go.

- 1 Holding the top, grab the bottom and fold together.
- 2 Fold the remaining two outer sides inwards.
- 3 Flip over and pull the back side towards your body.
- 4 Adjust the edges to form a circle and store it inside the carry bag.

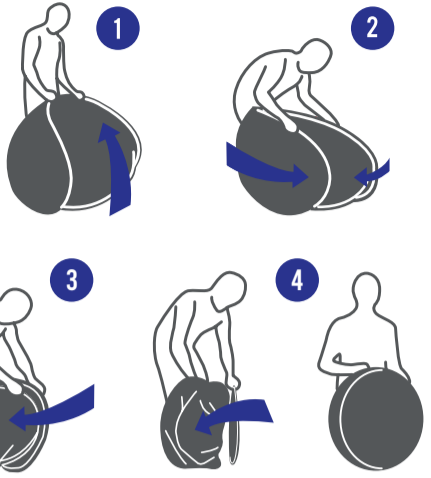

Ask for a hand! With the green screen being large, having another person to help will make the process easier.

## Troubleshooting



Wrinkles on background

- Spray the green screen with water and stretch it out tight as it dries to reduce the wrinkles and lines.

Dirt marks and debris on background

- Clean your green screen using only mild soap and water; do not use cleaning solutions.

Large shadows on background

- Appropriately distance between the person/model and the green screen. Trial with the background lighting and person/model until no dark shadows on the green screen are visible.
- Remove the wrinkles as this may create shadows on the background.



## Specifications

Green Screen Size 200 x 150 cm

Net Weight 2.8kg

## Give us a call



What? You mean this User Guide didn't have ALL the answers? Speak to us! We'd love to help you get up and running as quickly as possible.

Call our **After Sales Support** on **1300 002 534**.  
Operating hours: Monday-Friday, 8:30am-6pm  
Saturday, 9am-6pm AEST

## Enjoy using your new product!

Well done, you made it. Now sit back and relax... your new product is automatically covered by a 1-year warranty. How nice!

