

**BAUHN®**

**65"**

**4K**

Ultra HD  
Smart TV

MODEL: ATV65UHDS-1020



User Manual



# Welcome

Congratulations on your purchase!

This manual tells you all you need to know about using your new BAUHN® product.

Please take special note of any important safety and usage information presented with the  symbol.

All products brought to you by BAUHN® are manufactured to the highest standards of performance and safety and, as part of our philosophy of customer service and satisfaction, are backed by our comprehensive 1 Year Warranty.

We hope you will enjoy using your purchase for many years to come.

# Contents

Welcome	2	TV Setting Menus	21	Recording	40
Unpack and Prepare	4	Picture	23	Recording Live TV	41
What's in the box	4	Sound	25	Scheduled Recording	41
 Important Tips	5	Setting	26	Playback	41
Attaching the stand	6	Time	28	Pause Live TV (Time-shift)	42
Wall-mounting the TV	7	Lock	29	USB Mode	43
Connect to power	8	PVR Option (Personal Video Recording)	30	Set up	43
Connect your antenna	8	Program	31	Troubleshooting	45
Controls and Connections	9	Network	32	Specifications	48
Get to know your TV	9	About	34	Compliance and Responsible Disposal	49
Buttons on the TV	9	High Dynamic Range (HDR)	35	Warranty Information	50
Ports on the TV	10	Smart TV	36	Repair and Refurbished Goods or Parts Notice	51
Remote Control	13	Smart TV Applications	36		
Setup	13	Screencast	37		
Using the Remote Control	14	App Portals	37		
Standard Remote	15	Web Browser	38		
Easy Remote	17	TV Guide	39		
On-Screen Set Up	18				
Networking	19				
Connecting to a Wireless Network	19				
Connecting to a Wired Network	20				

# Unpack and Prepare

## What's in the box

Before installing your new TV, check you have everything needed.

In the box you will find:

- A. 65" 4K Ultra HD Smart TV
- B. Remote Control
- C. Easy Remote Control
- D. AAA Activ Energy Batteries
- E. TV Stands
- F. Screws for TV Stands
- G. Warning Sheet
- H. TV Toppling Safety Message
- I. Quick Start Guide
- J. Warranty Certificate
- K. General Safety Warnings
- L. User Manual



See the flap of the box for how to handle the TV without damaging it!

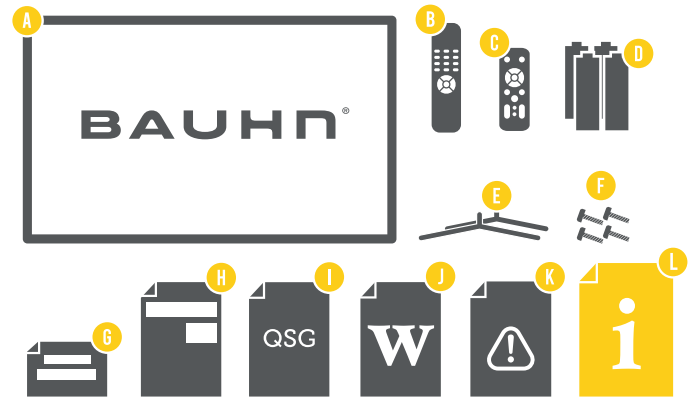

You will need:

- Phillips-head screwdriver (for stand installation)
- Someone to help you lift and install your TV
- Antenna cable (to watch live TV)
- Broadband internet connection (to use smart apps)

## Important Tips

- Place the TV on a level surface.
- Place the TV away from any source that may generate heat or vibrations.
- Make sure there is enough space around vents for airflow.
- The remote control works up to 5 metres away from the TV.
- Unplug the TV before cleaning it.
- Clean using a dry cloth only - do not use water or chemicals.
- Use only the power supply provided.
- It is highly recommended to use safety straps for securing the TV in place.
- Keep liquid, children and pets away from the TV at all times.

## Attaching the stand

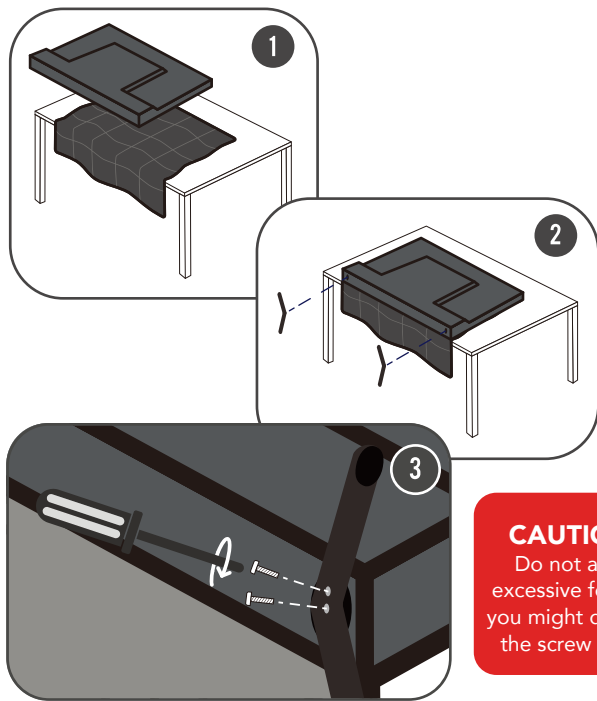

**CAUTION!**  
Do not apply excessive force as you might damage the screw holes.



- This TV is heavy! We recommend asking someone to help you lift it.
- Unplug the TV from the power outlet before installing or removing the stand.
- **DO NOT** place the TV standing upright without its stand attached; it could damage the remote sensor at the bottom of the TV.
- Only touch the frame, not the screen.
- It is highly recommended to use safety straps for securing the TV.

Unless you are wall-mounting the TV, you will need to attach its stand/legs.

1. Lay the TV face-down on a soft, flat surface (like the sofa, or a towel on a table) larger than the TV itself.
2. Match the stands to the installation points on the underside of the TV.
3. Attach the stands to the TV at the installation points using the screws provided. (Grab a screwdriver for this bit).

# Wall-mounting the TV



- Unplug the TV from the power outlet before wall-mounting.
- Contact a professional for assistance with wall-mounting the TV.

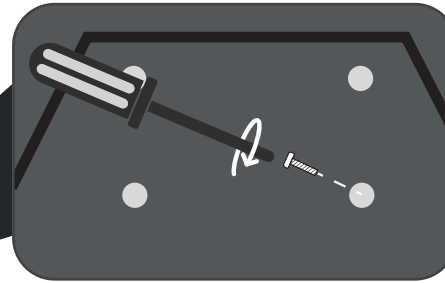
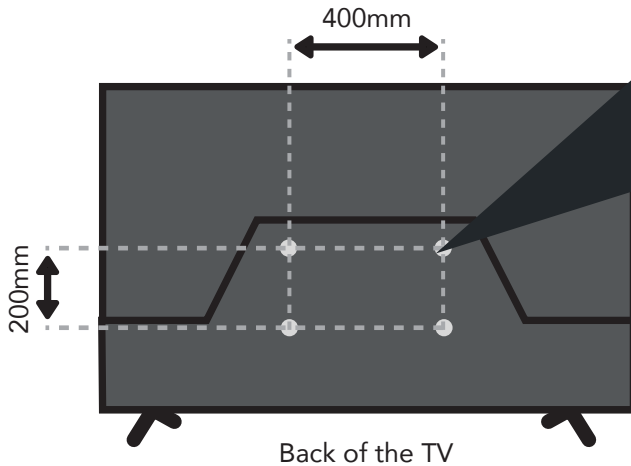

## Required

- VESA Mounting Bracket
- 4 x M6\*12mm screws (or longer as required)

The TV comes with holes on the back panel for use with wall-mounting brackets (bracket not included).

Use four standard M6\*12mm screws (or longer, depending on the mounting bracket) to wall-mount this TV (screws are not included).



The screws in the package are for securing the TV stand only. If you are wall-mounting the TV, consult a qualified installer for advice on bracket support and wall support.

## Connect to power

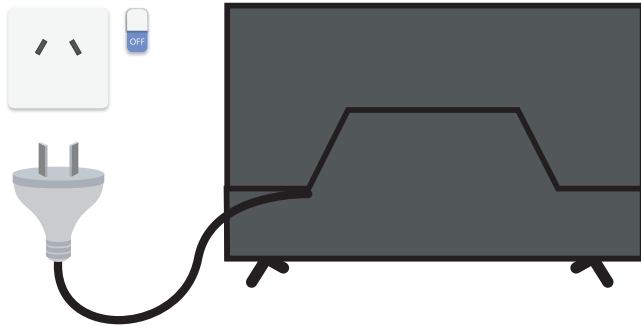

## Connect your antenna

### Free-to-air TV in HD (High Definition)

Example  
HD Channels

ABC HD  
SBS ONE HD  
7HD  
9HD  
10 HD  
PRIME7 HD  
WIN HD

High Definition (HD) channels provide the best viewing quality and are available with a digital antenna connection.

TV channels in Ultra HD resolution are not currently available in Australia. Therefore when you watch HD broadcast signals on an Ultra HD TV, the picture can appear 'soft' and lacks the detail you see when watching the same content on an HD TV.



Don't forget to plug in the TV to the power outlet. Leave the power switched off until installation is finished.



Make sure the TV is **switched off** at the power outlet until you have finished connecting your cables.

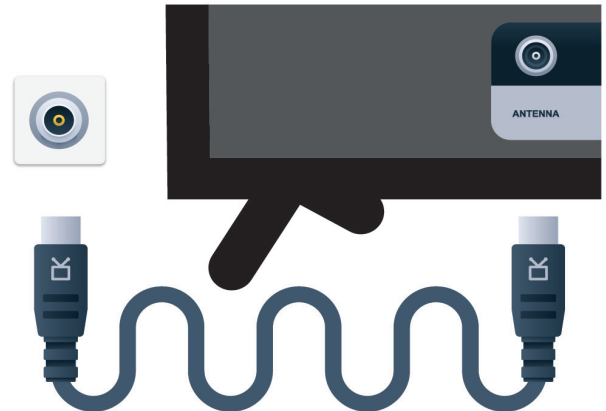

Antenna cable not included.



# Controls and Connections

## Get to know your TV



## Buttons on the TV

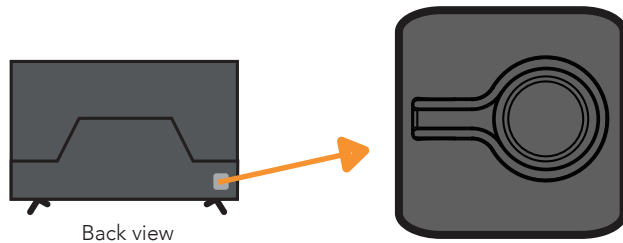

- When the TV is on standby, press this button to turn the TV on.
- When the TV is on, press to turn the TV off.

# Ports on the TV



1 ANTENNA IN  

FREE-TO-AIR TV







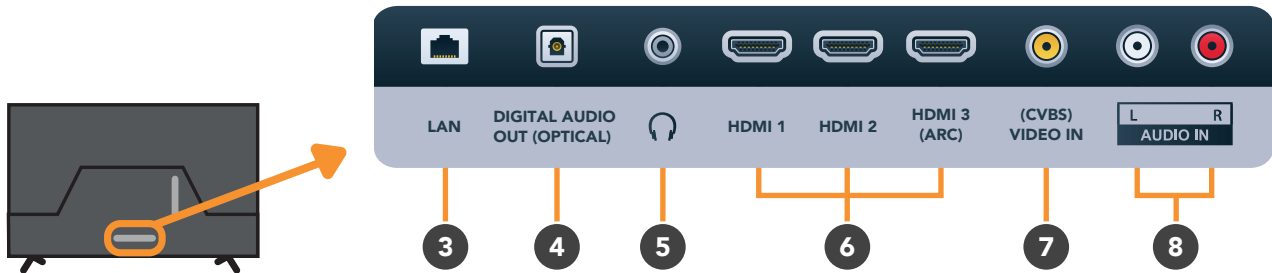

Connect your antenna for live TV. (Antenna cable not included).

2 USB  

STORAGE

- PVR record and pause live TV
- Play your stored media files (supported file codecs and extensions may vary)
- Software updates



3	LAN			INTERNET	Connect to your broadband modem using an Ethernet cable (not included) for best streaming experience. However, the TV also has built-in wifi.
4	DIGITAL AUDIO OUT (OPTICAL)			SOUND	Connect an external digital audio device. Use an Optical cable (not included) to connect the unit with an amplifier, soundbar or other audio decoding device for digital audio signal output.
5	Headphone Jack			SOUND	Connect to your headphones, amplifier or audio device, using an AUX cable (not included).
6	HDMI			SOUND PICTURE COMPUTER	All-digital connection between the TV and any HDMI device. Supports Ultra HD resolution. Requires a high-speed HDMI cable not included).

Use a high-speed HDMI cable for best picture and sound quality.

More on next page 

7

VIDEO IN



SOUND

You can use this to connect your DVD player. Supports Standard Definition (SD) picture quality. Requires an AV cable (not included).

8

AUDIO IN

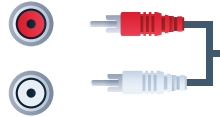

SOUND

You can use this to connect Audio to your TV for AV or Component video inputs. Requires an AV cable (not included).

# Remote Control

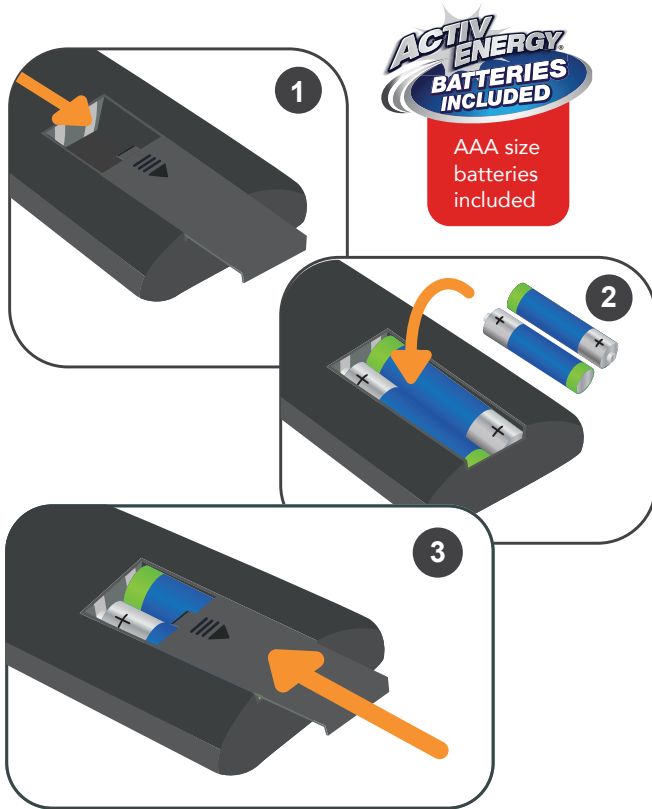

## Setup

Insert two AAA size batteries according to the polarity markings (+/-) inside the compartment. Make sure the batteries are correctly aligned and properly pushed into place.



### Precautions When Using Batteries

- Do not use old and new batteries together.
- Do not use different types of batteries (e.g. Manganese and Alkaline batteries) together.
- Remove the batteries from the remote if you do not intend to use it for a long time.
- When discarding used batteries, follow any guidelines for recycling and disposal of batteries that apply in your local area.
- Keep batteries away from children and pets.
- Never throw batteries into a fire or expose them to extreme heat.

## Using the Remote Control

To use the remote, point it towards the remote sensor at the front of the TV. The remote will not operate if its path is blocked.

The remote has a range of up to about 5 metres from the TV at an angle of up to 30 degrees to either side of the sensor, as illustrated below.

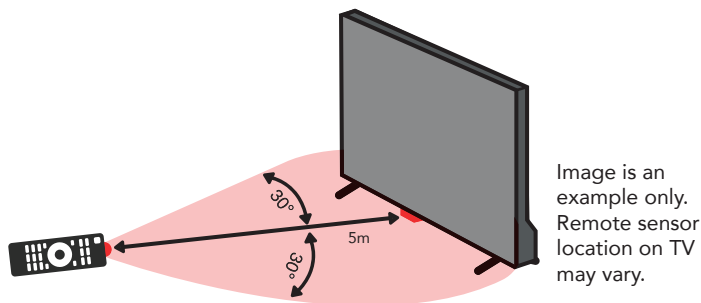

### Remote Hints and Tips

- Do not drop, step on or otherwise impact the remote control. This may damage the parts or lead to malfunction.
- Do not place objects between the remote control and the remote sensor.
- Do not use this remote control while simultaneously operating a remote control for other devices.

# Standard Remote



 **(ON)**: Switch the TV to On or Standby

**NUMBER BUTTONS**: Key in a TV channel number



**EPG**: Display Electronic Program Guide

 **(SOURCE)**: Select the input source

**+ V -** : Increase/decrease volume level

 **(MUTE)** :Mute or restore sound

 **TXT** :Enter teletext\*

 **P**  :Go to the next or previous program

 :Enter the Home page



\* Teletext is no longer available in Australia



: Access TV settings, Menu

: Press the **UP/DOWN/LEFT/RIGHT** buttons to navigate

**BACK**: Return to the previous screen/ menu

**NETFLIX** : Launch the Netflix app

: Launch the Amazon Prime Video app

**RED/GREEN/YELLOW/BLUE**: Functions are according to the on-screen display.

: Rewind the track

**(RECORD)**: Record live TV

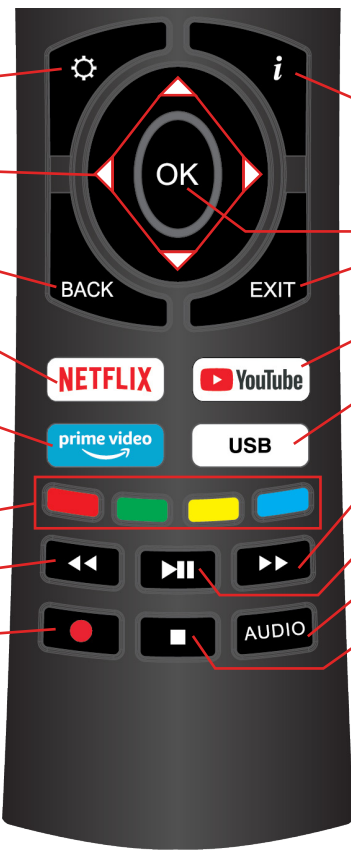

**i (INFO)**: Display program information

**OK**: Confirm your selection

**EXIT**: Exit/quit the current screen

**YouTube** : Launch the YouTube app

**USB** : Enter USB mode

: Fast forward the track

: Play/pause content

**AUDIO**: Change language

: Stop playback



# Easy Remote



**⏻ (POWER):** Switch the TV to On or Standby

**▲ / ▼ / ◀ / ▶:** Press the **UP/DOWN/LEFT/RIGHT** buttons to navigate

**↶ BACK:** Return to previous screen/menu

**🏠 HOME:** Access streaming apps, TV settings

**+ VOL - :** Turn the volume up or down

**GUIDE:** Launch the TV Guide (DTV)

SOURCE

**📺 SOURCE:** Switch the input source

**OK:** Confirm your selection

**📺 EXIT:** Exit/Quit the current screen

**⏪ CH ⏩:** Go to the next or previous channel

**🔇 :** Mute the sound. Press again or press VOL+ to restore the sound



# On-Screen Set Up



Make sure equipment is properly connected (as shown on pages 10-12) before connecting the TV to power.



On/Standby light is RED in standby mode.

On/Standby light is OFF when the TV is on.

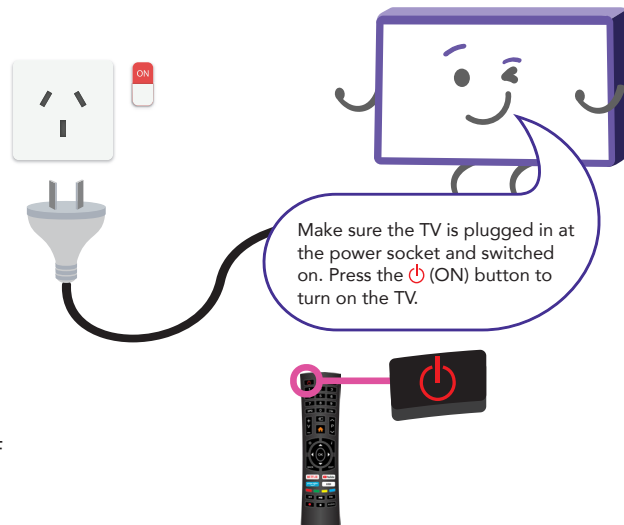

## First Time Setup menu

When you turn the TV on for the first time, the First Time Setup menu will appear.

Follow the prompts using the ▲ / ▼ / ◀ / ▶ / OK buttons to select your preferences. You will be guided through:

1. Language   2. Data Collection and Firmware Update   3. Country

4. Connect to the Internet   5. Select Input Source   6. Channel Tuning

Note: If you choose to setup Netflix or select an input source other than DTV, the set up wizard will exit and will not let you tune TV channels.

To tune channels, go to Menu > Program > Auto Tuning.

## 4. Connect to the Internet

If you are using a wired network, connect an ethernet cable to the TV and select 'wired'. The TV will automatically connect to the Internet.

If you are using a wireless connection, select 'Wireless'. The TV will scan for nearby wireless networks. Make sure that the TV is within the range of your wireless modem/router, and you have your Wi-Fi password handy.







Or, you can connect to the internet later by going to the User Menu settings.

If you make an error, you can update your preferences in the settings menu later.

# Networking

You can set up your TV so that it can access the Internet through your home network using a wired or wireless connection.

## Connecting to a Wireless Network

- Press the  button on the remote to select TV Settings > Network.
- Change network type to 'Wireless' and press ok. The TV will automatically search nearby Wi-Fi access points. When done, it will display a list of available networks.
- In the list of networks, press the  /  button to select your home network, then press the OK button.
- When the Wi-Fi password entry screen appears, use the on-screen keyboard. Use the  /  /  /  buttons on the remote control to select a character and press OK to enter it.
- Input the correct password, select 'Connect' and press the OK button to connect to the network. If connection is successful, a tick will appear next to your Wi-Fi networks's name.

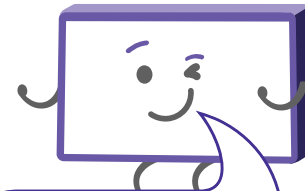

If the TV isn't connecting to the internet check the troubleshooting section for more info!



# Connecting to a Wired Network

- Connect an ethernet cable to the LAN port on the back of the TV.
- Press the ⚙️ button on your remote to select TV Settings > Network.
- Change the Network Type setting to 'Wired'. The TV will automatically pick up the network setting from the modem and connect to the network. If connection is successful, you will see 'Connected' on-screen.
- Press the **EXIT** button to close the menu.

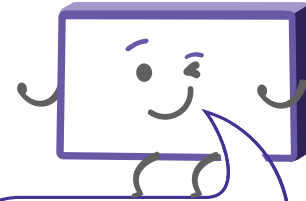

Make sure you have an ethernet cable on hand if you want to connect to a wired network



# TV Setting Menus

## Menu Navigation Buttons

Press the  button and select TV Settings. See the guide below for all the other buttons you'll need to use to adjust and change your settings.



Once you have programmed any settings, the unit will retain them in its memory until you change them, even after turning the TV off.

### Function Remote Button

Display the main menu	
Enter a sub menu	<b>OK</b>
Select an option	<b>▲ / ▼</b>
Adjust a value	<b>◀ / ▶</b>
Return to the previous menu	<b>BACK</b>
Exit a menu	<b>EXIT</b>









## Menus Index



### Picture

23

- Picture Mode
- User Mode Settings:
  - Contrast, Brightness, Colour, Sharpness, Tint
- Backlight
- Colour Temperature
- Aspect Ratio
- Noise Reduction
- Open HDR

 <u>Sound</u> <span style="float: right;">25</span> <ul style="list-style-type: none"> <li>• Sound Mode</li> <li>• Equalizer</li> <li>• Balance</li> <li>• Auto Volume Limit</li> <li>• Surround Sound</li> <li>• AD Switch</li> <li>• Digital Output Type</li> <li>• Audio Type</li> <li>• Audio Delay</li> </ul>	 <u>Lock</u> <span style="float: right;">29</span> <ul style="list-style-type: none"> <li>• Lock System</li> <li>• Set Password</li> <li>• Parental Guidance</li> </ul>  <u>PVR Option (Personal Video Recording)</u> <span style="float: right;">30</span> <ul style="list-style-type: none"> <li>• PVR File System</li> <li>• Start Record</li> <li>• Start Timeshift</li> <li>• Recorded Files</li> </ul>	 <u>About</u> <span style="float: right;">34</span> <ul style="list-style-type: none"> <li>• Netflix: <ul style="list-style-type: none"> <li>• Netflix Deactive, Terminate Netflix, Netflix ESN, Netflix Version</li> </ul> </li> <li>• View End-User License Agreement</li> <li>• System Information</li> <li>• NetReady Information</li> <li>• Software Update (USB)</li> <li>• Internet Update Check</li> </ul>
 <u>Setting</u> <span style="float: right;">26</span> <ul style="list-style-type: none"> <li>• Language</li> <li>• OSD Time</li> <li>• HDMI-EDID</li> <li>• HBBTV</li> <li>• Link (HDMI-CEC) Setup <ul style="list-style-type: none"> <li>• Link (HDMI-CEC)</li> <li>• HDMI-ARC (Audio-Return Channel)</li> <li>• Auto Power</li> <li>• Auto Standby</li> </ul> </li> <li>• Time</li> <li>• Environment</li> <li>• Reset</li> </ul>	 <u>Program</u> <span style="float: right;">31</span> <ul style="list-style-type: none"> <li>• Auto Tuning</li> <li>• DTV Manual Tuning</li> <li>• ATV Manual Tuning</li> <li>• Signal Information</li> </ul>	 <u>High Dynamic Range (HDR)</u> <span style="float: right;">35</span>
	 <u>Network</u> <span style="float: right;">32</span> <ul style="list-style-type: none"> <li>• WiFi: Auto Scan, Manual Input</li> <li>• Ethernet: Protocol, Configuration, Connect</li> <li>• Wake on LAN</li> <li>• Wake on WLAN</li> </ul>	

# Picture



## Picture Mode

**Dynamic** : Enhanced brightness with lower contrast, colour depth and edges.

**Standard** : Default picture settings suitable for a dark room.

**Movie** : Settings are optimised for viewing movies.

**User** : Adjust settings to best suit your viewing environment and content.

### User Mode settings

Option	Description
Contrast	Adjust the contrast of the bright and dark areas of the picture. The closer to 100, the higher the contrast.
Brightness	Adjust the overall screen brightness. The closer to 100, the brighter the picture.
Colour	Adjust the saturation. The closer to 100, the deeper the colour.
Sharpness	Adjust the sharpness of the picture. The closer to 100, the sharper and clearer the image.
Tint	Adjust the colour balance between red and green. (Only available with NTSC video standard. Australia uses PAL video standard.)



To adjust the brightness, change the Picture Mode to User and modify the Brightness setting.



Option	Description
Backlight	Adjust the screen brightness by adjusting the backlight. The closer to 100, the brighter the screen.
Colour Temperature	Adjust the on-screen colour temperature.
Aspect Ratio	This item is used to adjust the video size. Sizes may differ between input sources.
Noise Reduction	Reduces screen noise/static.
Open HDR	Select high-dynamic range setting (TV must be receiving an HDR signal for this setting to be active.)



# Sound

Option	Description
Sound Mode	<b>Standard</b> <b>Music</b> <b>Movie</b> <b>Sport</b> <b>User</b>
Equalizer	Adjust selected frequencies. These options are available when sound mode is set to personal.
Balance	Adjust the audio output between the left and right speakers.
Auto Volume Limit	Adjust the increase or decrease of audio when you change channels, video sources or content.
Surround Sound	Adjust surround sound effect from your TV speakers.
AD Switch	Audio Description (AD) provides an additional audio track for visually challenged persons (DTV only, subject to program).
Digital Output Type	Select digital output type.
Audio Type	Select audio type.
Audio Delay	S/DPDIF Delay: Synchronize the sound from the external speakers (when using Optical Audio Out connection) with the TV picture. Speaker delay: Synchronize the sound from the TV speakers with the TV picture. HDMI-ARC delay: Synchronize the sound from the external speakers (when using HDMI-ARC connection) with the TV picture.



# Setting



Option	Description
Language	Select your preferred On screen display, Audio and Subtitle language.
OSD Time	Set the preferred amount of time for the OSD to be displayed on the screen.
HDMI-EDID	Auto, 1.4 (2K), 2.0 (4K). Select 2.0 (4K) when the source signal is transferred by HDMI 2.0 Specification. Select 1.4 (2K) when the source signal is transferred by HDMI 1.4 Specification.
HBBTV	Switch the HbbTV function On or Off. (Not supported).
Link (HDMI-CEC) Setup	See the next page for information.
Time	See page 28 for more information.
Environment	Home mode (recommended) is for general home viewing. Shop (Store) mode is for in-store demo purposes.
Reset	Restore the system settings to the factory default. When the restore is complete, the TV will restart.

## Link (HDMI-CEC) Setup

This feature allows for your TV and your connected HDMI device to be controlled by one remote control. It also means you can turn them both on or off simultaneously.

Make sure to select the correct HDMI input source.

Option	Description
Link (HDMI-CEC)	Turn HDMI-CEC On/Off.
HDMI-ARC (Audio Return Channel)	If this function is enabled, sound from the TV can be sent to a HDMI-ARC supported external audio device.
Auto Power	When this is set to On, turning on the TV will also turn on the connected device.
Auto Standby	When this is set to On, turning off the TV will also turn off the connected device.



Not all HDMI cables are the same! Be sure to use a high-speed HDMI cable.

## Time

Option	Description
Auto Sync	On: Automatically syncs TV clock according to the DTV broadcasting time. Off: Manually adjust the clock.
Clock	Displays the DTV signal time or set the time manually.
Off Time	Set the time and day to turn off the TV.
On Time	Set the time and day to turn on the TV.
Sleep Timer	Select the desired Auto Sleep (Standby) duration.
Auto Sleep	Sets the time when the TV will enter Standby mode due to inactivity.
Time Zone	Adjust your timezone.

# Lock

Enter the factory password '0000' using the number buttons on the remote and select 'OK' on-screen. If you changed your password but forgot it, you can still use the master password.



Factory Password: 0000  
Master Password: 8899

Option	Description
Lock System	Turn system lock on/off.
Set Password	Input a new password using the number buttons on the remote and confirm to set the new password.

## Parental Guidance

This item is used to block access to specific program ratings. See options down below.



No Block

Block G  
and above

Block PG  
and above

Block M  
and above

Block MA  
and above

Block AV  
and above

Block R  
and above

Block All

Unrestricted



General



Parental guidance  
recommended



Recommended for  
mature audiences



Not suitable for  
people under 15.  
Under 15s must be  
accompanied by a  
parent or adult  
guardian

Not suitable for  
people under 15.  
Under 15s must be  
accompanied by a  
parent or adult  
guardian



Restricted to 18 and  
over

Restricted

# PVR Option (Personal Video Recording)

To make changes to PVR (Personal Video Recording), ensure your USB drive is inserted into the TV. Check the troubleshooting section if you're having problems setting up your USB device.

Option	Description
PVR File System	<p>Enter submenu in DTV mode.</p> <ul style="list-style-type: none"><li>• Select Disk: Select the USB drive</li><li>• Select Partition: Select the disk partition if there are any multiple partitions on the disk.</li><li>• Time Shift Size: Select the memory size for the Time Shift function. Options: 512MB, 1GB, 2GB, 4GB.</li><li>• Format: Format the connected USB.</li><li>• Speed: Checks the speed of the storage device.</li></ul>
Start Record	Start recording.
Start Timeshift	Start Timeshift function.
Recorded Files	View list of recorded files.

# Program



## Option

## Description

### Auto Tuning

Automatically tunes all available free-to-air TV channels. Adjust settings (default settings are set for Australia), select 'Search' and press OK.

### DTV Manual Tuning

Manually select and tune digital TV channels.

### ATV Manual Tuning

Manually select and tune analog TV channels. (Analog TV is no longer supported in Australia).

### Signal Information

Display current signal information (DTV mode only).



# Network

You can set up your TV so that it can access the Internet through your home network using a wired or wireless connection.

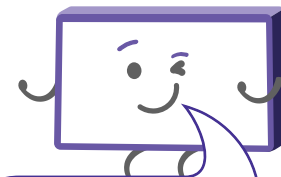

Make sure you have an ethernet cable connected to the TV

Option	Description
Wi-Fi	See below for more information.
Ethernet	See next page for more information.
Wake on LAN	Turn On/Off Wake On LAN function.
Wake on WLAN	Turn On/Off Wake On WLAN function.

## Wireless Network Settings

Option	Description
Auto Scan	Scan and display nearby available networks.
Manual Input	Manually enter SSID (network name), password, security mode to connect to a hidden network.



## Wired Network Settings

Option	Description
Protocol	Change Internet protocol from IPv4 > IPv6
Configuration	DHCP: Automatically receive network addresses from the W-Fi router. Static: Manually enter IP, Netmask, Gateway, DNS network addresses.
Connect	Select to connect.

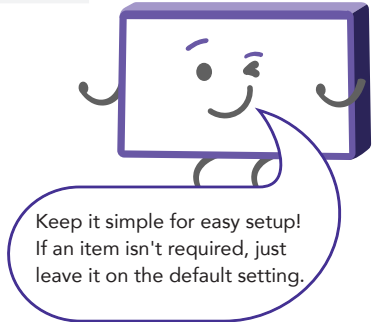

# About



Option	Description
Netflix	Enter Netflix submenu. <ul style="list-style-type: none"><li>• Netflix Deactivate: Select to deactivate Netflix.</li><li>• Terminate Netflix: Select to terminate Netflix.</li><li>• Netflix ESN: Display the Netflix ESN information.</li><li>• Netflix Version: Display the Netflix version.</li></ul>
View End-User License Agreement	Read and accept/decline the End-User-License Agreement (EULA).
System Information	Display system information.
NetReady Information	Display current software version information.
Software Update (USB)	Update the TV software via USB.
Internet Update Check	Update the software using the internet.

# High Dynamic Range (HDR)



## About the HDR feature

High Dynamic Range (HDR) is a picture feature on your TV that attempts to mimic the way visuals are perceived in real life by the human eye.

By using this feature, the TV can reproduce greater dynamic range of luminosity by capturing and then combining several different exposures.

HDR promises better picture quality thanks to brighter, more realistic highlights, more realistic colour and other improvements.

It delivers the look that the filmmakers intended to achieve, showing the hidden areas of dark shadows and sunlight with full clarity, colour and detail.

## HDR on your TV

HDR is supported in HDMI and USB input sources.

**NOTE:** When watching HDR content, make sure the Menu > Picture > Open HDR is set to Auto, Low, Middle or High. This requires an HDR playback-capable external media player and HDR optimised media content. Use a High-Speed HDMI cable when connecting to an external media player.





# Smart TV

Before you start using apps, your TV must be connected to the internet.

The speed of your internet connection determines the quality of your audio/video experience when you watch streaming content.

Accessing internet content may count towards your download limit and may incur fees from third parties such as your internet service provider (ISP).

Function	Remote Button
Display the Home/App screen	
Select different apps	
Open your desired app	<b>OK</b>

## Smart TV Applications

- Netflix
- YouTube
- Prime Video
- Facebook
- Twitter
- Smart TV Apps
- Yahoo
- Youtube Kids
- Screencast
- Browser



You cannot download any extra apps on this TV.

## NETFLIX

Netflix is a streaming service that offers unlimited viewing of a wide variety of award-winning TV shows, movies and documentaries.

A paid subscription is required.

This TV can play Netflix content in 4K UHD HDR resolution, however the playback resolution may be lower depending on your subscription level and your network speed.

Streaming Netflix content will count towards the data usage of your broadband plan.

## Screencast

The Screencast feature enables you to echo the display from a compatible Android device like a smartphone or tablet on the TV screen by connecting your mobile device directly to the TV wirelessly. In order to use this feature, your device must support Wi-Fi Display technology.

 Apple iOS operating system is not supported.

To start using the Screencast feature, select the Screencast icon and press OK to load the app.

Turn on Wi-Fi and Wireless Display (a.k.a. Wi-Fi Display, Wi-Fi Direct, Cast Screen) function on your smart phone or tablet (Please refer to your device's user manual for information on how to turn on wireless display).

Your mobile device will display a list of available devices. Choose "Screencast" and click on it to connect.

Your mobile device will connect to the TV and will display the device screen on the TV.

Use your device to disconnect.

## App Portals

The NetRange app portal gives you access to other content and service providers.

Some apps may require a paid subscription.

Streaming content will count towards the data usage of your broadband plan.

# Web Browser

Using the web browser, you can surf the Internet on the TV similar to how you would do on a PC.

**NOTE:** Use a wired or wireless keyboard and mouse (not provided) for an easier web browsing experience.

From the Home page, select a recommended or bookmarked site and click **OK** to visit the site.

Press the **RED** / **RED** button to bring out the address bar.

Press the **OK** button on the address bar to type the web address. You can enter the web address using the on-screen keyboard, remote keyboard or connected wireless keyboard.

Select the 'Add to bookmark' icon and press **OK** to add the web address as a favourite.

Select the 'Settings' icon to access the browser menu settings.

Press the **EXIT** to exit the web browser.

## On-screen keyboard

Use **▲** / **▼** / **◀** / **▶** buttons and press **OK** to enter the character.

Use **GREEN** / **GREEN** and **YELLOW** / **YELLOW** buttons to move the cursor left and right.

Press **RED** / **RED** button to enter.

Press **BLUE** / **BLUE** button to delete (backspace).

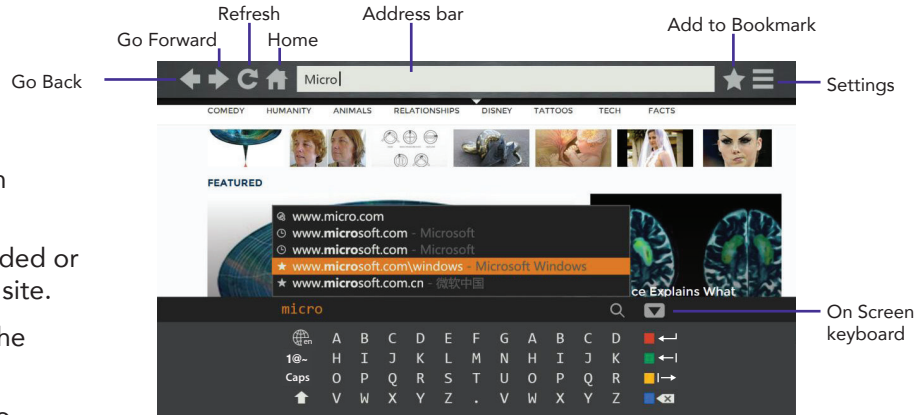

# TV Guide

(Free to air TV)

## TV Guide Functions

Function	Remote Button
Select a channel or program	▲ / ▼ / ◀ / ▶
Schedule selected program for recording	RED
Display program guide of previous day	GREEN
Display program guide for next day.	YELLOW
Show program information	<i>i</i>
Set program reminder	BLUE
Exit TV Guide menu	EXIT



To access the TV guide, press the **EPG** button on the remote.

To activate the TV Channels use the ▲ / ▼ buttons to select a channel in the left column, then press OK to confirm.



# Recording

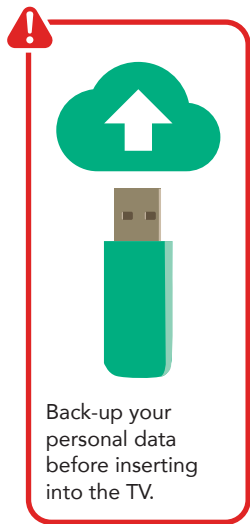

## Important Tips:

- Back-up your personal data before plugging in your USB to the TV. We do not assume liability for any loss of data due to misuse or malfunction.
- You cannot change channels while in recording mode.
- If the signal is interrupted while in recording mode, the recording will stop until the signal is established.
- Do not turn the TV off while it is in time-shift mode.
- The file recorded can only be used on this TV. Do not copy it to any other device.
- When connecting or disconnecting the USB storage device, ensure the TV is not in USB mode, otherwise the USB device or the files stored on it may be damaged.





Before you can record with this TV (including time-shift recording), you must insert your USB storage device into the USB port.



## Recording Live TV

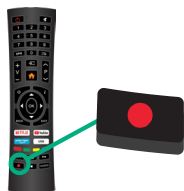

### Start Recording

Press **RECORD** once, then **OK** to start recording.

### Stop Recording

Press **STOP** once - display the dialogue box.

Select **YES** to stop recording.

Select the **NO** button to continue recording.

## Scheduled Recording

See TV Guide Functions on page 39 to schedule recordings and view schedules.



When a program is being recorded in the background (while the TV is in standby mode), the Standby/On light will flash red.



Recording, scheduled recording and pause live TV functions only work in DTV mode (free-to-air).

## Playback

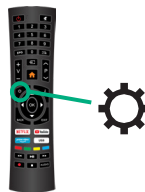

Press the **gear** button then navigate to System then PVR File System then Record List to display the list of recorded programs.

Use the **▲ / ▼** buttons to select a recorded file.

Press the **OK** button to start playback in Full Screen Mode.

# Pause Live TV (Time-shift)

Temporarily pause the live TV signal, then resume playback at your convenience.



The USB storage device won't retain recorded data after you exit the time-shift function.



Before you can record with this TV (including time-shift recording), you must insert your USB storage device into the USB port.



## Start Time-shift

Press the **▶||** button on the remote to enter time-shift mode.

Press the **▶||** button to resume playing the program.



## Stop Time-shift

Press the **■** button to exit time-shift.

# USB Mode





## Set up

Insert your USB into a USB port on the TV.

Press the  (**SOURCE**) button to select 'Media' mode.



You can only play Photos in the Photo category, Music in the Music category and so on. Make sure you select the correct category for the file you wish to play.

Function	Remote Button
Navigate media categories and file system	 /  /  / 
Start playing your media	
Return to the previous screen	<b>BACK</b>
Exit USB mode	<b>EXIT</b>



## Playback Functions

Playback of different media types have different controls.

### Photo

Function	Remote Button
Navigate to a folder or file	◀ / ▶ / ▲ / ▼
Select files	<b>OK</b>
Display a photo	▶
Return to file list	<b>BACK</b>

### Music

Function	Remote Button
Navigate to a folder or file	◀ / ▶ / ▲ / ▼
Select tracks	<b>OK</b>
Play a track	▶
Fast forward or rewind the track	◀◀ / ▶▶
Return to file list	<b>BACK</b>



# Troubleshooting

If you experience problems with your TV, check below for advice. If you don't find a solution here, contact After Sales Support on 1300 886 649.

Problem	Solution
No power	<p>Check the power outlet is turned on.</p> <p>If using a multi-outlet, check if it is working properly. To check whether a power strip is working properly, plug the TV's power plug directly to a wall outlet and observe its operation.</p> <p>Try to power on using the button on your TV set.</p>
Picture issues	<p>Ensure that all equipment is connected properly. If you are using an external device, turn it off, then turn it on again. If it says there is no signal on the screen, choose the correct source input.</p> <p>Adjust the antenna position.</p> <p>Move the TV away from electronic equipment or devices that could cause interference.</p> <p>Auto-tune free-to-air TV channels again.</p> <p>Try another channel.</p> <p>If the image keeps flickering when trying to connect the HDMI cable, make sure the cable is correctly connected to the port; and not faulty (bent or broken).</p> <p>Adjust menu &gt; Setting &gt; HDMI EDID.</p>
Network connection issues	<p>Turn off the modem and the router (if used). Wait for 2 minutes and then turn them back on.</p> <p>If you are connecting using Wi-Fi, make sure you enter the Wi-Fi password correctly.</p> <p>If you are using a static IP, enter the IP address and other network addresses directly.</p> <p>If you are using an ethernet cable, use one rated CAT 5 or higher. Make sure it is plugged in at both ends.</p> <p>If the problem persists, contact your Internet Service Provider or modem manufacturer.</p>



Problem	Solution
Sound issues	<p>Ensure that the equipment is connected properly.</p> <p>Ensure that the input setting for the TV is correct.</p> <p>Ensure audio settings on the external device are set correctly.</p> <p>Ensure the volume is not muted. If it is, press the MUTE button to restore the sound.</p> <p>If earphones are connected, unplug them.</p> <p>Adjust the volume to a suitable level by pressing the + V - buttons.</p> <p>If you are using an external audio device, check that the Menu &gt; TV Settings &gt; Sound &gt; Digital Audio Output setting is 'PCM'.</p> <p>If you are using an external audio device via an HDMI cable, make sure the audio device supports HDMI-ARC.</p> <p>Adjust HDMI EDID Settings (Menu &gt; Setting &gt; HDMI EDID).</p>
No operations can be performed with the remote control unit	<p>Check the batteries are correctly installed.</p> <p>The batteries may be exhausted: replace them.</p> <p>Make sure to point the remote control at the remote control sensor and try it again.</p> <p>Make sure to use the remote control at a distance of no more than 5m from the sensor.</p> <p>Remove any obstacles between the remote control and remote control sensor.</p>
Button operation is not effective (unit and/or remote control)	<p>Disconnect the power plug and then reconnect it. (The unit may not be operating properly due to lightning, static electricity or other factors.)</p>



## Problems relating to your USB media storage device

Problem	Solution
<p>My TV does not recognise my USB device or my external hard disk</p>	<p>First, refer to the instructions describing how to use USB devices with this TV.</p> <p>If the problem still occurs, your USB device may not be compatible.</p> <p>This TV has been tested with the majority of Flash memory-based devices and hard disks (media players with HDD) on the market; however, it may not be compatible with certain devices, in particular external self-powered hard disks.</p> <p>Some USB storage devices may not be compatible with this TV.</p> <p>Only use a USB storage device formatted in a FAT32 file system provided with the Windows operating system. If it is formatted by a different utility program that is not supported by Windows, it may not be recognised.</p>
<p>'Disk not ready' error</p>	<p>When you are in time-shift recording mode, without removing the USB recording device, you may experience some difficulty with a scheduled recording. You will need to remove the USB device as it is required to reset after each recording to protect the device from damage. If you see the message 'DISK NOT READY' displayed, remove the device, reconnect and proceed with your recording.</p>
<p>My media is loading slowly</p>	<p>For large file sizes and large capacity storage devices, the loading speed may be slower. The recognition speed of a USB storage device may vary depending on the device.</p>
<p>There is an 'unsupported file' message</p>	<p>If an "Unsupported File" message is displayed, it means the file extension, video codec, image resolution or frame rate is unsupported.</p>



# Specifications

<b>Active screen size (diagonal)</b>	163.9cm	
<b>Resolution</b>	3840 x 2160	
<b>Aspect ratio</b>	16:9	
<b>Refresh rate</b>	60Hz	
<b>HDMI version</b>	2.0	
<b>HDCP version</b>	2.2	
<b>Multimedia playback formats (USB mode)</b>	Video	AVI, MPG, MKV, MP4, H.264, H265, MKV
	Music	MP3
	Photo	JPG/JPEG
<b>USB output</b>	DC 5V 500mA	
<b>Power supply</b>	AC 180-240V, 50/60Hz	
<b>Power consumption</b>	160W	

<b>Dimensions (W x D x H)</b>	With stand: 1461.5 x 259.8 x 907.6 mm	
	Without stand: 1461.5 x 83 x 845 mm	
<b>Weight</b>	Net	18.4kg
	Gross	23.5kg

## For Technical and Warranty Support

1300 886 649

[www.tempo.org](http://www.tempo.org)

[info@tempo.org](mailto:info@tempo.org)

Distributed by Tempo (Aust) Pty Ltd,  
PO Box 6056, Frenchs Forest DC 2086



# Compliance and Responsible Disposal



## Packaging

The packaging of your product has been selected from environmentally friendly materials and can usually be recycled. Please ensure these are disposed of correctly. Plastic wrapping can be a suffocation hazard for babies and young children, please ensure all packaging materials are out of reach and are safely disposed of. Please recycle these materials rather than throwing them away.



## Product

At the end of its working life, do not throw this product out with your household rubbish.

An environmentally friendly method of disposal will ensure that valuable raw materials can be recycled. Electrical and electronic items contain materials and substances which, if handled or disposed of incorrectly, could potentially be hazardous to the environment and human health.



## National Television and Computer Recycling Scheme

The careful disposal of e-waste is important because many televisions and computers contain materials which are hazardous to people and the environment. There are no fees for householders or small businesses disposing of e-waste at a scheme collection service.

Individuals can contact their local council for information on local e-waste management services, find scheme services listed on Planet Ark's website at [www.recyclingnearyou.com.au](http://www.recyclingnearyou.com.au), or call Planet Ark on 1300 733 712.

## Compliance

This product complies with the Australian Safety Standard AS/NZS 60065 to ensure the safety of the product.



# BAUHN®

## Warranty Information

The product is guaranteed to be free from defects in workmanship and parts for a period of 12 months from the date of purchase. Defects that occur within this warranty period, under normal use and care, will be repaired, replaced or refunded at our discretion, solely at our option with no charge for parts and labour. The benefits conferred by this warranty are in addition to all rights and remedies in respect of the product that the consumer has under the Competition and Consumer Act 2010 and similar state and territory laws.

Our goods come with guarantees that cannot be excluded under the Australian Consumer Law. You are entitled to a replacement or refund for a major failure and to compensation for any other reasonably foreseeable loss or damage. You are also entitled to have the goods repaired or replaced if the goods fail to be of acceptable quality and the failure does not amount to a major failure.





## Repair and Refurbished Goods or Parts Notice

Unfortunately, sometimes faulty products are manufactured, which need to be returned to the supplier for repair.

Please be aware that if your product is capable of retaining user-generated data (such as files stored on a computer hard drive, telephone numbers stored on a mobile telephone, songs stored on a portable media player, games saved on a games console or files stored on a USB memory stick) during the process of repair, some or all of your stored data may be lost. We recommend you save this data elsewhere prior to sending the product for repair.

You should also be aware that rather than repairing goods, we may replace them with refurbished goods of the same type or use refurbished parts in the repair process.

Please be assured though, refurbished parts or replacements are only used where they meet ALDI's stringent quality specifications.

If at any time you feel your repair is being handled unsatisfactorily, you may escalate your complaint. Please telephone us on 1300 886 649 or write to us at:

Tempo (Aust) Pty Ltd ABN 70 106 100 252  
PO Box 6056, Frenchs Forest, NSW 2086, Australia  
Telephone: 1300 886 649 (Aust) - Fax: (02) 9975 2688  
Tempo Help Desk: 1300 886 649 (Aust)  
(Operating Hours: Mon-Fri 8:30am-6pm; Sat 9am-6pm AEST)  
Email: [info@tempo.org](mailto:info@tempo.org)



## Online support

Visit [www.bauhn.com.au](http://www.bauhn.com.au) for software updates to keep your TV up-to-date, as well as the latest User Manual for information on the updated features.

## Warranty returns

Should you for any reason need to return this product for a warranty claim, make sure to include all accessories with the product.

## Product does not work?

If you encounter problems with this product, or if it fails to perform to your expectations, please contact our After Sales Support Centre on 1300 886 649 before returning it to the store for a refund.