



Please read the User Guide

It will help you get the best out of your product.

Still have questions?
Call After Sales Support
1300 886 649
Or visit www.tempo.org

Warranty returns

Should you for any reason need to return this product for a warranty claim, make sure to include all accessories with the product.

Product does not work?

If you encounter problems with this product, or if it fails to perform to your expectations, make sure to contact our After Sales Support Centre on 1300 886 649 before returning it to the store for a refund.

13

Alarm

When using the alarm function, you need to set it via the FunDo Pro app. Navigate to the "More" page then "Set an alarm." After an alarm is set, and the watch is connected to the app, the alarm clock set inside the app can be synchronized to the watch. Up to five alarm clocks can be set. Pressing on the icon can stop the vibration alert during the vibration alert process.

Music

After the mobile phone is connected to the watch, while the phone is playing music, tap on the Music icon to control music by playing/pausing and switching songs on the watch.

14

Weather

The weather page will display the current weather, and the weather message will not be available until the APP client is connected. If the connection is disconnected for a long time, the weather message will not be updated.

Timer

Use the + and - icon to set the timer, then press the blue triangle icon to start the countdown.

Find Phone

After the watch is connected with the FunDo Pro app, tap on the "FindPhone" icon on the watch, then your smart phone will ring. Tap on the watch again to exit.

15

Stopwatch

Press the stopwatch icon to enter the timing interface, press the start icon to start timing, the icon on the left is a single timing record, and the icon on the right is paused. After pausing, press on the top single timing record to view the records at different times. The left slide on the screen exits and the previous timing is cleared.

Settings

Brightness

Tap on the + or - icon to adjust screen brightness.

Backlight

Tap on the + or - icon to adjust the screen auto turn off time. This can be set from 3 to 10 seconds.

16

Camera

After the watch is connected with the FunDo Pro app, tap "Remote shutter" on the "More" page to open your smart phone camera. The watch will automatically enter the camera icon page. Tap the icon on the watch screen to take a photo.

Sedentary

To turn sedentary reminders on or off, open the FunDo Pro app and navigate to the settings for "More" -> "Sedentary reminder" page.

Flip over

Turn this setting on to automatically turn on the screen when raising your arm. If you turn this setting off, you need to press the side button to turn on the screen.

Reset

Restore all settings to the factory state.

QR code

Scan for the FunDo Pro app.

About

Display the product name, hardware address and software version.

Change The Straps

Turn the watch over (see below), push the needle knob to the right to take off the original strap, then fit the new strap.



17

Specifications

Display	1.3", 240 x 240 pixels
Ingress protection	IP67
Charging time	3 hrs (approx.)
Charging base input	5V=120mA
Bluetooth Range	< 10m
Built-In Battery	Li-ion 3.7V 170mAh
Weight	41g
Dimensions (mm)	38(W) x 40(H) x 11(D)

The Bluetooth® word mark and logos are registered trademarks owned by Bluetooth SIG, Inc. and any use of such marks by Hands (IP) Holdings Pty Ltd is under license. Other trademarks and trade names are those of their respective owners.

18

BAUHN®

Warranty Information

The product is guaranteed to be free from defects in workmanship and parts for a period of 12 months from the date of purchase. Defects that occur within this warranty period, under normal use and care, will be repaired, replaced or refunded at our discretion, solely at our option with no charge for parts and labour. The benefits conferred by this warranty are in addition to all rights and remedies in respect of the product that the consumer has under the Competition and Consumer Act 2010 and similar state and territory laws.

Our goods come with guarantees that cannot be excluded under the Australian Consumer Law. You are entitled to a replacement or refund for a major failure and to compensation for any other reasonably foreseeable loss or damage. You are also entitled to have the goods repaired or replaced if the goods fail to be of acceptable quality and the failure does not amount to a major failure.

Repair and Refurbished Goods or Parts Notice

Unfortunately, sometimes faulty products are manufactured, which need to be returned to the supplier for repair.

BAUHN®

Please be aware that if your product is capable of retaining user-generated data (such as files stored on a computer hard drive, telephone numbers stored on a mobile telephone, songs stored on a portable media player, games saved on a games console or files stored on a USB memory stick) during the process of repair, some or all of your stored data may be lost. We recommend you save this data elsewhere prior to sending the product for repair.

You should also be aware that rather than repairing goods, we may replace them with refurbished goods of the same type or use refurbished parts in the repair process.

Please be assured though, refurbished parts or replacements are only used where they meet ALDI's stringent quality specifications.

If at any time you feel your repair is being handled unsatisfactorily, you may escalate your complaint. Please telephone us on 1300 886 649 or write to us at:

Tempo (Aust) Pty Ltd ABN 70 106 100 252
PO Box 6056, Frenchs Forest, NSW 2086, Australia
Telephone: 1300 886 649 (Aust) - Fax: (02) 8977 3765
Tempo Help Desk: 1300 886 649 (Aust)
(Operating Hours: Mon-Fri 8:30am-6pm; Sat 9am-6pm EST)
Email: info@tempo.org

19

BAUHN®



Smart Watch User Guide



AFTER SALES SUPPORT

1300 886 649

info@tempo.org

Model: AFTW-0820

Product Code: 702335 08/2020

20

Parts of the watch



1. Touch screen
2. Side button
3. Heart rate sensor
4. Charging pins

First Time Use

Charge your watch before using for the first time, you will need to charge it for about 3 hours.

2

Charging steps:

1. Place the watch on top of the base with the charging points on the back of the watch aligned with the charging pins on the charging base. It will snap into position once correctly aligned.

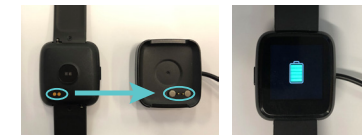

2. Plug the USB charging dock into a USB charging adaptor (not included) or a USB port on your computer.
3. Once fully charged, unplug the charging dock from the charger.

3

FunDo Pro App

Search for the FunDo Pro app in the app store to download, or scan the QR code below for installation.



For Android



Google Play and the Google Play logo are trademarks of Google LLC.

Apple, the Apple logo, iPhone, and iPad are trademarks of Apple Inc., registered in the U.S. and other countries and regions. App Store is a service mark of Apple Inc.

For iOS



4

Turn on the Watch

Once the watch is fully charged, press and hold the side button for 5 seconds to turn on the watch. To turn off the watch, press and hold the side button for 5 seconds.

Connect to the App

Open the FunDo Pro app on your smart phone. On the main page, tap on the "More" icon then "+Add device." On the device list, select "AFTW0820" to connect to the watch. On iOS devices, you may need to tap on "Pair" on a pop up window.

5

Disconnect from the App

Open the FunDo Pro app. Tap on the "More" page, then tap on "AFTW0820" then tap "OK" to disconnect the watch. On iOS devices, you will also need to open the Settings menu on your iPhone. Go to Bluetooth settings, tap on the "i" icon on the right side of "AFTW0820" and then tap 'Forget This Device' to finish disconnecting.

Turn On the Screen

To turn on the screen, raise your arm if you're wearing the watch, or press the side button. Press the button again to turn off the screen. Press the side button on any screen or swipe right to exit or return to the previous screen. Raising your arm too quickly or slowly may not turn the screen on.

6

Functions On the Home Screen

- Swipe left to get to the main menu. From here, swipe left/right to navigate to different menu screens.
- Swipe down for the quick settings menu. From here, swipe down again to go back to the home screen.
- Swipe right for the notifications screen.
- Press and hold the screen for the watch face selection page. Swipe left/right for different options, then tap the screen again to select.

Note: There are 3 watch faces available. The time format (12/24hours) is synced with your phone settings.

7

Functions in any Screen

- Swipe right or press the side button to return to the previous screen.
- Tap on any icon to get into the sub screen.
- Tap the touch button to go to the home screen.

Applications

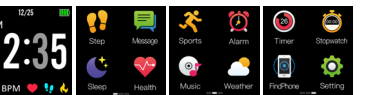

Please allow permission and enable the notification settings on the respective smart phone application.

Step

On the main menu, tap on the Step icon to enter the Step app. The Step app acts as a pedometer and will track the number of steps taken and calories burnt.

8

Message

On the main menu, tap on the Message icon to enter the Message app to view text messages. To display incoming calls and messages or notifications from other applications installed on your smart phone, you need to turn on notifications on the FunDo Pro app. To do this, go to "More" -> "App notification settings." The Message app will store your last 8 messages, after the limit is reached, the previously displayed message will be deleted.

Sleep

On the main menu, tap on the Sleep icon to enter the Sleep app. The Sleep app allows you to track your sleep patterns for a 12 hour period. Tap the refresh button on the top left of the screen each time to see the updated data.

9

On the FunDo Pro app home page, tap on the watch icon on the upper left corner to synchronise data between your smart watch and the FunDo Pro app, it will take a few seconds to sync the sleep data.

Health

On the main menu, tap on the Health icon to access heart rate monitoring, blood pressure monitoring and blood oxygen levels. For accurate measurements, ensure the following:

- The smart watch has good contact with your wrist.
- Check that the sensor is clean and there is no dirt or debris covering it.
- It may take over 30 seconds before the first result is shown on the screen.

10

NOTE: The results and measurements of health and sleep data cannot be used for medical reference and should be used as a guide only.

Sports

On the main menu, tap on the sport mode icon to enter the multi-sport screen. The smart watch has eight activities: Walking, Running, Cycling, Climbing, Football, Basketball, Table Tennis and Badminton.

When you want to pause the activity, tap the top right corner of the screen. To stop the activity tracking, tap the top left corner of the screen.

The smart watch will only save activity data if the distance is more than 200m and 5 minutes in duration.

11